



Aluminium endmill

# EPN-AL • EPA-AL

Volume 1.2



# KEY FEATURES: EPN-AL • EPA-AL SERIES

---



# EPN-AL-3FS

Milling | Solid carbide

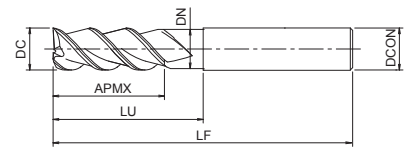
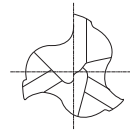

- Carbide end mill, bright finish
- For aluminium and copper alloys
- 3 flutes, short length of cut



line Plus
CARBIDE
40°
h6
h6
45°

EDP	ZEFP	DC	CHW	LU	LF	APMX	DCON	DN
EP019703	3	3	0,05	7	50	4	6	2,8
EP019704	3	4	0,05	8	54	5	6	3,8
EP019705	3	5	0,1	9	54	6	6	4,8
EP019706	3	6	0,1	15	54	7	6	5,8
EP019708	3	8	0,1	17	55	9	8	7,8
EP019710	3	10	0,1	20	60	11	10	9,8
EP019712	3	12	0,2	24	70	12	12	11,8
EP019716	3	16	0,2	28	80	16	16	15,8
EP019720	3	20	0,2	32	82	20	20	19,8

Milling | Solid carbide





# EPA-AL-3FS

Milling | Solid carbide

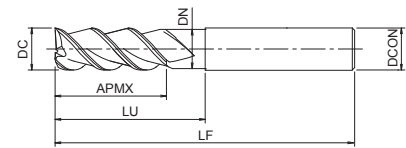
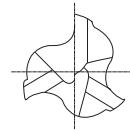
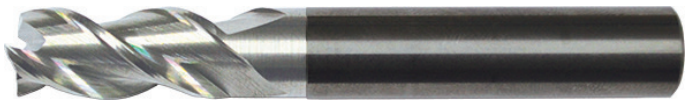

- Carbide end mill with ALC coating
- For aluminium and copper alloys
- 3 flutes, short length of cut



line  
**Plus**

CARBIDE

ALC

40°

h6

D=3  
-0,004 ~ +0,006

6 ≥ D > 3  
-0,006 ~ +0,006

10 ≥ D ≥ 8  
-0,007 ~ +0,006

16 ≥ D ≥ 12  
-0,009 ~ +0,006

D ≥ 20  
-0,011 ~ +0,006

45°

EDP	ZEFP	DC	CHW	LU	LF	APMX	DCON	DN
EP019903	3	3	0,05	7	50	4	6	2,8
EP019904	3	4	0,05	8	54	5	6	3,8
EP019905	3	5	0,1	9	54	6	6	4,8
EP019906	3	6	0,1	15	54	7	6	5,8
EP019908	3	8	0,1	17	55	9	8	7,8
EP019910	3	10	0,1	20	60	11	10	9,8
EP019912	3	12	0,2	24	70	12	12	11,8
EP019916	3	16	0,2	28	80	16	16	15,8
EP019920	3	20	0,2	32	82	20	20	19,8

Milling | Solid carbide



# EPA-AL-3FL

Milling | Solid carbide

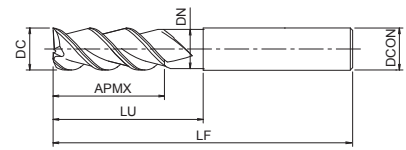
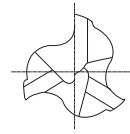

- Carbide end mill with ALC coating
- For aluminium and copper alloys
- 3 flutes, long length of cut



CARBIDE

ALC

40°

h6



EDP	ZEFP	DC	CHW	LU	LF	APMX	DCON	DN
EP020003	3	3	0,05	12	57	9	6	2,9
EP020004	3	4	0,05	16	57	11	6	3,8
EP020005	3	5	0,1	18	57	13	6	4,8
EP020006	3	6	0,1	20	57	13	6	5,8
EP020008	3	8	0,1	25	63	19	8	7,8
EP020010	3	10	0,1	32	72	22	10	9,8
EP020012	3	12	0,2	38	83	26	12	11,8
EP020016	3	16	0,2	50	92	32	16	15,8
EP020020	3	20	0,2	62	104	38	20	19,8

Milling | Solid carbide

# CUTTING CONDITIONS

Milling | Endmills | Cutting conditions

## EPN-AL-3FS/FL

Side milling

	Aluminium wrought alloys	Aluminium cast alloy >5% Si <10% Si
Vc	400 - 600 (m/min)	350 - 500 (m/min)
Ø	fz (mm)	fz (mm)
3	0,027	0,024
4	0,036	0,032
5	0,045	0,041
6	0,054	0,049
8	0,072	0,065
10	0,090	0,081
12	0,108	0,097
16	0,144	0,130
20	0,195	0,175
ae max. 60% x D ap = 1xD		

Slotting

	Aluminium wrought alloys	Aluminium cast alloy >5% Si <10% Si
Vc	400 - 600 (m/min)	350 - 500 (m/min)
Ø	fz (mm)	fz (mm)
3	0,019	0,017
4	0,025	0,022
5	0,032	0,029
6	0,038	0,034
8	0,050	0,046
10	0,063	0,057
12	0,076	0,068
16	0,101	0,091
20	0,137	0,123
ap = 1xD		

## EPA-AL-3FS/FL

Side milling

	Aluminium wrought alloys	Aluminium cast alloy >5% Si <10% Si
Vc	500 - 800 (m/min)	400 - 700 (m/min)
Ø	fz (mm)	fz (mm)
3	0,027	0,024
4	0,036	0,032
5	0,045	0,041
6	0,054	0,049
8	0,072	0,065
10	0,090	0,081
12	0,108	0,097
16	0,144	0,130
20	0,195	0,175
ae max. 60% x D ap = 1xD		

Slotting

	Aluminium wrought alloys	Aluminium cast alloy >5% Si <10% Si
Vc	500 - 800 (m/min)	400 - 700 (m/min)
Ø	fz (mm)	fz (mm)
3	0,019	0,017
4	0,025	0,022
5	0,032	0,029
6	0,038	0,034
8	0,050	0,046
10	0,063	0,057
12	0,076	0,068
16	0,101	0,091
20	0,137	0,123
ap = 1xD		





shaping your dreams

**OSG EUROPE LOGISTICS**

Avenue Lavoisier 1  
B-1300 Z.I. Wavre - Nord - Belgium  
Tel: +32 10 23 05 07  
info@osgeurope.com

**OSG POLAND Sp. z o.o.**

Spółdzielcza 57  
05-074 Halinów - Poland  
Tel: +22 760 82 71  
osg@osg-poland.com

**OSG ROMANIA SRL**

25C, Bucuresti-Magurele Street (Sector 5)  
051431 Bucuresti - România  
Tel: +40 21 322 07 47  
info@osgromania.ro

**OSG BELUX**

Avenue Lavoisier 1  
B-1300 Z.I. Wavre - Nord - Belgium  
Tel: +32 10 23 05 11  
info@osg-belgium.com

**OSG GERMANY**

Karl-Ehmann-Str. 25  
D - 73037 Göppingen - Germany  
Tel: +49 7161 6064 - 0  
Fax: +49 7161 6064 - 444  
info@osg-germany.de

**AUSTRIA**

Branch office of OSG GERMANY  
Messestraße 11  
A-6850 Dornbirn  
Tel: +49 7161 6064-0  
info@osg-germany.de

**OSG FRANCE**

Parc Icade, Paris Nord 2  
Immeuble "Le Rimbaud"  
22 Avenue des Nations  
CS66191 - 93420 Villepinte - France  
Tel: +33 1 49 90 10 10  
sales@osg-france.com

**OSG SCANDINAVIA**

(For Scandinavian countries)  
Langebjergvaenget 16  
4000 Roskilde - Denmark  
Tel: +45 46 75 65 55  
osg@osg-scandinavia.com

**OSG ITALIA**

Via Ferrero, 65 A/B3  
I - 10098 Rivoli - Italy  
Tel: +39 0117705211  
info@osg-italia.it

**OSG NETHERLANDS**

Bedrijfsweg 5 - 3481 MG Harmelen  
Tel: +31 348 44 2764  
info@osg-nl.com

**SWEDEN**

Branch office of OSG SCANDINAVIA  
Singelgatan 7  
212 28 Malmö - Sweden  
Tel: +46 40 41 22 55  
osg@osg-scandinavia.com

**Vischer & Bolli AG**

Machining and Workholding  
Im Schossacher 17  
CH-8600 Dübendorf  
T +41 44 802 15 15  
info@vb-tools.com

**OSG UK**

Kelsey Close, Attleborough Fields Ind Est,  
CV11 6RS, Nuneaton, United Kingdom.  
Tel: +44 1827 720 013  
uk\_sales@osg-uk.com

**OSG IBERICA**

Bekolarra 4  
E - 01010 Vitoria-Gasteiz - Spain  
Tel: +34 945 242 400  
osg.iberica@osg-ib.com

**CZECH, SLOVAKIA, HUNGARY**

OSG Europe Logistics S.A.  
Slovakia organizacna zlozka  
Racianská 22/A, SK-83102 Bratislava  
Slovakia  
Tel. +421 24 32 91 295  
Orders-osgsvk@osgeurope.com

**OSG TURKEY**

Rami Kışla Cad.No:56 Eyüp  
Istanbul 34056 - Turkey  
Tel+90 212 565 24 00  
Fax: +90 212 565 44 00  
info@osg-turkey.com

**OSG EUROPE LOGISTICS S.A.**

06/2023 - All rights reserved. © OSG Europe 2023

The contents of this catalogue are provided to you for viewing only. They are not intended for reproduction either in part or in whole in this or other medium. They cannot be copied, used to create derivation work or used for any reason, by means without the express, written permission of the copyright owner. If prices are stated, they are netto unit-prices and any eventual tax(es) have to be added. The company is not responsible for any printing error in technical, price and/or any other data.

Tool specifications subject to change without notice.

[www.osgeurope.com](http://www.osgeurope.com)

